

FRONT FENDERS

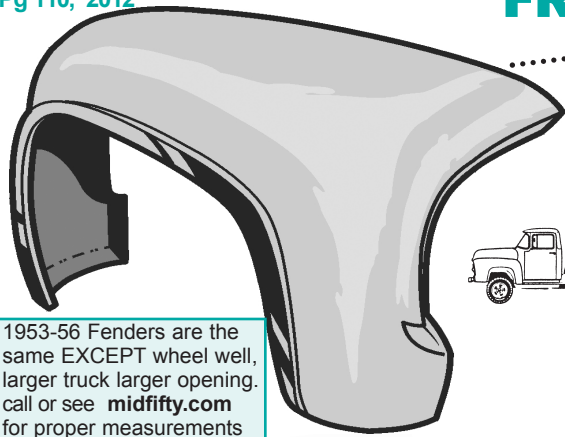

FRONT STEEL FENDERS

Very good reproductions, best available fit like an original, 18 gauge steel, fender is complete all holes are punched.

DRIVER7701-L	\$350.00 ea.
PASSENGER7702-R	\$350.00 ea.

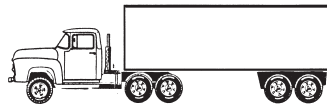

All Fenders are shipped by truck. Freight charges can be collect or prepaid. Estimated freight cost (call for quote, freight charges change often these days)
Four can sometimes go as cheap as 2.
Boxing charge is \$20.00 ea. See pg. 3 for directions.

1953-56 Fenders are the same EXCEPT wheel well, larger truck larger opening. call or see midfifty.com for proper measurements

FIBERGLASS PRODUCTS VARY IN QUALITY AND PRICE.
WE STAND BEHIND FIBERGLASS PRODUCTS WE SELL (3 YR. WARRANTY)
THEREFORE WE OFFER ONLY QUALITY PIECES.

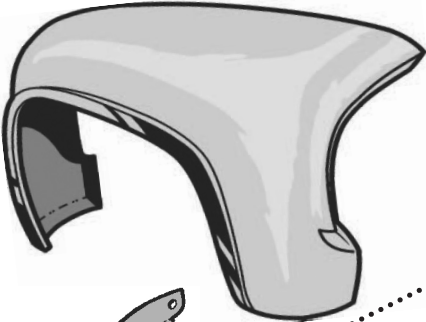

FRONT FIBERGLASS FENDER

Highest quality Front corner design makes installation easy. Nice underside, smooth gelcoat, all components permanently bonded. Mounting holes not drilled but are marked. Very Nice Fender. 3 YR. GUARANTEE

DRIVER6600-L	\$250.00 ea.
PASSENGER6600-R	\$250.00 ea.

FRONT COWL & FENDER REINFORCEMENT BRACE,

Piece on inside of cab that fender bolts through, includes fender locating nut, this is where to start aligning fenders, rust or fatigue here can cause misalignment.

Left1562-L	\$20.00 ea.
Right1562-R	\$20.00 ea.

FRONT FENDER UPPER MOUNTING BRACKET Common rust and problem area, this piece holds the fender and is often the cause of fender or hood alignment problems if fatigued, bent, rusted or misaligned. If the truck has been hit this small piece will bend and forever cause hood and fender problems.

DRIVER1563-L	\$22.50 ea.
PASSENGER1563-R	\$22.50 ea.

INNER FENDER TO LOWER CAB MOUNTING ANGLE BRACKET

56 short style was made in China and was not quite right so we redid them all here. 1953-55 were longer and caught the inner fender with both bolts, the 56 was shorter and only came to the first bolt. They each interchange so you can use the long style on a 56 or the short on a 53-55.

1956 Driver, short1564-L	\$22.50 ea.
1956 Passenger, short1564-R	\$22.50 ea.
1953-55 Driver, long1564-5355L	\$22.50 ea.
1953-55 Passenger, long1564-5355R	\$22.50 ea.
CAGE NUTS, set of 881564	\$8.50 set

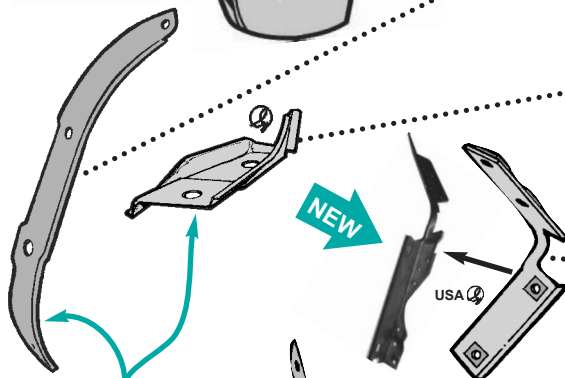

These two pieces solve many hood & fender alignment problems

FRONT FENDER BRACE,

Steel, order Left or Right1538-L or R	\$18.50 ea.
Polished Stainless, Driver1539-LPS	\$26.00 ea.
Polished Stainless, Passenger1539-RPS	\$26.00 ea.
F-250 Front Fender Brace, Polished.F2-1539-L or R	\$26.00 ea.

FRONT FENDER BRACE BOLT KIT

STAINLESS81538-SX	\$6.00 set
POLISHED STAINLESS, Hex Head81538-PX	\$14.00 set
POLISHED STAINLESS, Button Head81538-PB	\$14.50 set

FENDER WELT

RUBBER, DIE CUT, shown1503-DC	\$12.50 pr.
RUBBER, UNCUT with PATTERN1504	\$8.00 pr.
RUBBER, FRONT & REAR1507	\$26.50 pr.
CHROME, FRONT & REAR1506	\$25.00 roll
FABRIC, BLACK1501-FAB	\$16.00 roll
FABRIC, COLORS, Ask for Samples1501-(Color)	\$29.50 roll

we make F-250 also

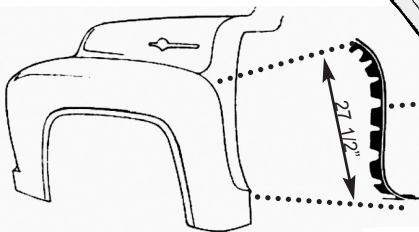

ALIGNMENT BUMPERS, set on fender2008	\$8.50 set
---	-------	-------	------------

