

6 VOLT, POSITIVE GROUND WIRING

THIS PAGE IS FOR 6 VOLT TRUCKS ONLY, IF YOU ARE LOOKING AT 6 VOLT AND ARE UNDECIDED, ANSWER THIS QUESTION.

Are you striving for exact, or as close to exact of original as possible? NO? then Don't even mess with 6V, Go 12V.

6 VOLT WIRING, all 1953, 1954 and 1955 trucks were originally 6 volt, Positive ground. The following pieces are cloth bound, proper color, correct wire size and include instructions. Originally some trucks had one round tail light and no turn signals depending on state regulations. 6 Volt wiring diagrams are available, ask, no charge. Or check out new laminated color schmatcs below.

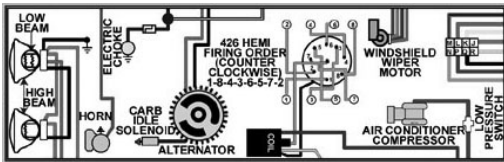
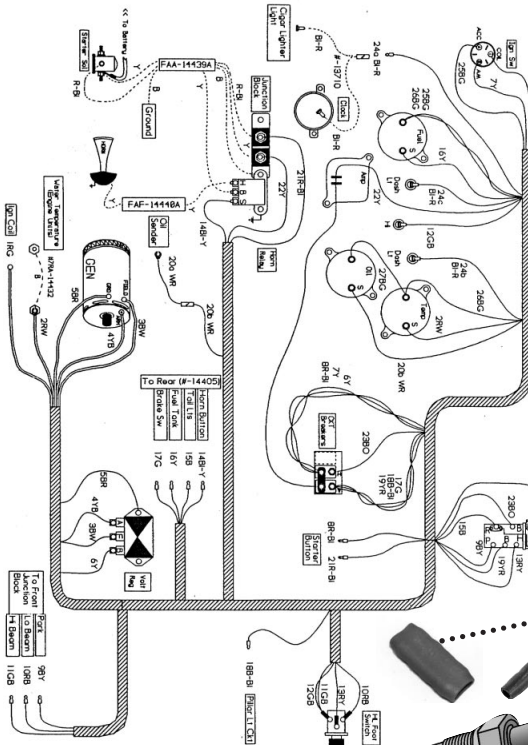

- 1953, 6 CYL DASH/COWL WIRING 6V-14401-FAL ... \$260.00 ea.
- 1953, 8 CYL DASH/COWL WIRING 6V-14401-FAK ... \$275.00 ea.
- 1954, 8 CYL DASH/COWL WIRING 6V-14401-FDE ... \$240.00 ea.
- 1955, 6 CYL DASH/COWL WIRING 6V-14401-E \$355.00 ea.
- 1955, 8 CYL DASH/COWL WIRING 6V-14401-B5C ... \$355.00 ea.
- 1956 SEE OUR KIT, IS CHEAPER AND HAS TURN SIGNALS, pg 50

1953 COIL TO DISTRIBUTOR 6V-14302-7RA \$5.50 ea
GENERATOR TO REGULATOR WIRING:

- 1953-54, 6 CYL 6V-14305-FAJ \$18.50 ea.
- 1954, 8 CYL 6V-14305-FDE \$19.50 ea.
- 1955, 8 CYL 6V-14305-FDM \$18.00 ea.

HEADLIGHT CROSSOVER WIRING 6V-13006-BTZ \$34.50 ea.
 Includes Park lights, and Horn wires

- HEADLIGHT SOCKET & PIGTAIL 6V-2235 \$22.50 ea
- 53-54 HORN RELAY TO HORN 6V-14440-FA \$19.00 ea.
- 1955 HORN RELAY TO HORN 6V-14440-B5C \$17.50 ea.
- 53-54 SOLENOID TO JUNCTION BOX 6V-14439-FAA \$42.00 ea.

TAIL LIGHT CROSS OVER WIRES
 BRAKES AND TURN SIGNALS 6V-14405-B5C \$69.50 ea.
 Harness comes from steering column with both Brake lights

- CONNECTOR, Needed for 6V ends, 4-way .3205 \$6.50 pr.
- Single 3205-1 \$2.25 pr.
- PARK-TAIL LIGHT SOCKET & PIGTAIL, single 6V-2213 \$15.00 ea.
- PARK-TAIL LIGHT SOCKET & PIGTAIL, Double 2213 \$4.50 ea.
- 53-54 FLAT HEAD TEMP X-OVER WIRE ... 6V-14432-7RA ... \$10.50 ea.
- NEUTRAL SAFETY SWITCH WIRES, 54-55 . 6V-14476-FDE ... \$32.00 ea.

- 6 VOLT ACCESSORIES**
- TEMP SENDER, SINGLE POST 6V-2941 \$50.00 ea.
 - TEMP SENDER, DOUBLE POST 6V-2942-2 \$50.00 ea.
 - CIGAR LIGHTER 6V-1003 \$28.50 ea.
 - FLASHER 6V-2920 \$9.50 ea.
 - GAS SENDING UNIT 6V-1603 \$45.00 ea.

SCHEMATIC, COLOR, 11 x 17, LAMINATED, close up of tiny piece shown.
 order year (1953-4) (1955) or (1956) B-3203 (yr) \$15.50 ea

- 6 VOLT BULBS**
- TAIL OR PARK LIGHT with Turn Signals . 6V-2260 \$1.50 ea.
 - PARKLIGHT, no turn signals 6V-2269 \$2.00 ea.
 - DOMELIGHT 6V-2269 \$2.00 ea.
 - DASH CLUSTER 6V-2618 \$1.90 ea.

***NOTE:** We do not recommend ceramic voltage reducers, they are unreliable, inconsistent & work by heating up causing a fire hazard.

- VOLTAGE REDUCERS, CERAMIC, we suggest "Electronic" below**
- 4 AM 1.5 OHM (Gauges) 3220 \$17.00 ea.
 - 6 AMP (HEATER & WIPER MOTORS) .3221 \$29.65 ea.

- ELECTRONIC VOLTAGE REDUCERS**
- For SINGLE GAUGES, one per gauge 3222 \$15.95 ea
 - For MULTIPLE GAUGES up to 1.5 amps .3223 \$63.00 ea
 - For MOTORS, heater & wiper 3223-4 \$69.50 ea

- 6 VOLT HEADLIGHT RELAY, 6V-3268 \$32.50 ea
- 6 VOLT ALTERNATOR, see pg 50 6V-3265 \$275.00 ea

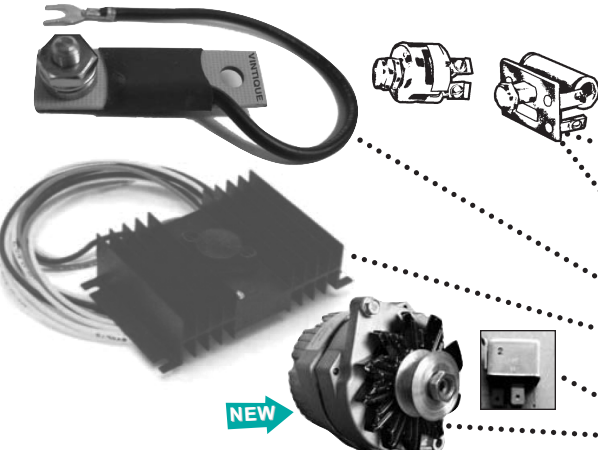

VOLTAGE REGULATORS, SOLENOIDS, HORN RELAY, HEADLIGHT SWITCH, ETC, SEE INDIVIDUAL LISTINGS

6 VOLT TO 12 VOLT SYSTEMS. updating to 12 volt negative ground will require a 12 volt generator or alternator (alternator is best choice). Stock gauges will work with an electronic voltage reducer. 6 volt heater and wiper motors will work with an electronic voltage reducer or just run them on low or replace. 6 volt starter will just run a little fast and maybe not last as long so may not be worth changing. Battery, Solenoid, & Coil need updated, points are ok. All the bulbs need changed to 12 volt.