

# BRAKE LINES • PARKING BRAKE

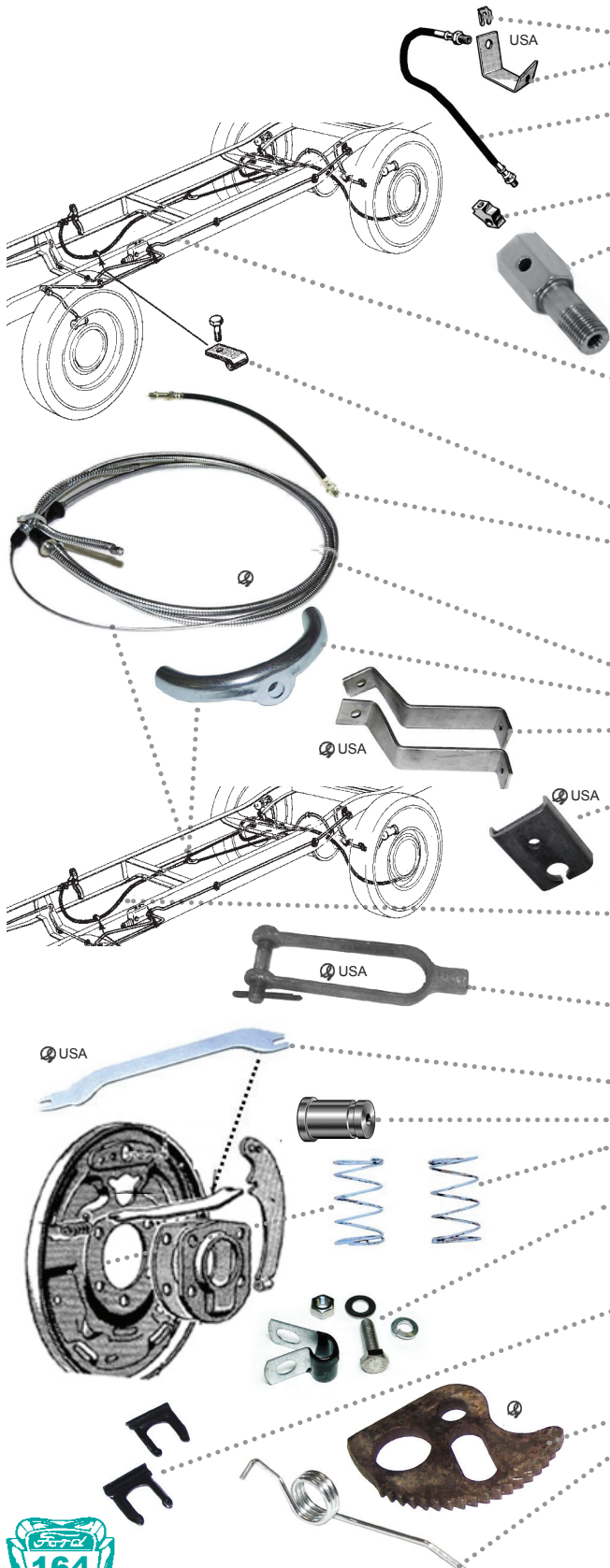

## BRAKE LINES AND HOSES

- Rear brake hose retaining clip.....0554 ..... \$1.90 ea
- Rear brake hose frame bracket.....0530..... \$9.50 ea
- Brake bracket bolt.....80530.....\$1.25 ea
- Rear brake hose.....0525.....\$24.00 ea

*Only one needed in center, goes to the center block fitting*

- Center fitting to hose washer.....0523..... \$1.20 ea
- Rear brake center block fitting.....0522..... \$18.50 ea
- Rear brake center block fitting, F-250 ....F2-0522 ..... \$18.50 ea
- Rear end vent, polished, long neck.....1336.....\$18.50 ea
- "S"line clip, joins fuel & brake line .....1636.....\$2.00 ea

### Steel brake lines

*For stock brakes, pre-bent 3/16" hard lines complete with proper ends and wrap installed, made from Ford specs.*

- Stainless.....5905-SS.....\$175.00 kit
- Stock steel.....5904-SK..... \$150.00 set

### D-Y-I brake line kit

*Includes 30 feet of tube, fittings, unions, spring wrap and clips*

- Stainless.....5901-S.....\$139.95 kit
- Plain steel.....5901-K.....\$75.00 kit
- Brake line clip & bolt.....0526..... \$1.50 ea
- Stock brakes front brake hose, use 2.....0524.....\$20.00 ea

## REAR PARKING/EMERGENCY BRAKE CABLE

*Goes to both rear wheels, fits stock rear end and most Ford 9 inch rear ends.*

- Stock rear cable with yoke .....0552..... \$52.50 ea
- Stock rear cable, no yoke.....0552-NY ..... \$42.00 ea
- Center yoke .....0556..... \$18.00 ea

*Got cable elsewhere? "Yokes on you" you need a yoke*

- Cable to frame bracket, steel, pair .....0560.....\$22.50 pr
- Cable to frame bracket, stainless .....0560-SS.....\$25.00 pr
- Bracket mounting bolts.....80560.....\$2.00 pr
- Rear cable mounting tab .....0563.....\$10.00 ea

*At crossmember secures brake cable, truck needs 2*

- Tab mounting bolts .....80563..... \$1.85 pr

## FRONT PARKING BRAKE CABLE

- Cable .....0551..... \$46.50 ea
- Front cable adjusting nuts .....80553..... \$0.50 set

*One for clevis below, and 2 for cable at yoke, adjusts tension*

- Front cable adjusting clevis .....0555.....\$12.50 ea
- Pin & cotter .....80555..... \$2.50 set

## BRAKE SPREADER BAR for E-brake .0542..... \$14.50 ea

## PULL LEVER LINK PIN.....0539..... \$2.75 ea

## SPREADER BAR SPRING .....0537.....\$4.00 pr

*1 pr per wheel*

## CABLE CLAMP & BOLT.....0526 ..... \$1.50 ea

## CABLE & HOSE RETAINER CLIP.....0554.....\$1.90 ea

*1 at front crossmember, 2 at rear crossmember, 1 at rear hose.*

## HORSE-SHOE CLIP AT HOSE AND CABLE ENDS

- Smaller of the clips (pair).....0553..... \$5.00 pr

## PARK BRAKE HANDLE .....Not available

- Handle bolts, polished stainless .....80551-PX.....\$8.50 kit

## PARKING BRAKE HANDLE REPAIR PIECES

- Sector gear, NOS .....0559..... \$20.00 ea
- Park handle inner repair spring .....0558..... \$8.25 ea

*Expensive but is most often problem with broken handle.*

