

# SPEEDOMETER

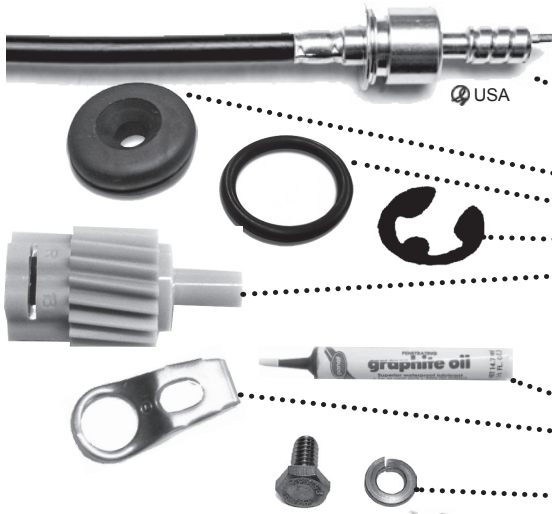

All our cables include inner drive cable, outer housing, 5/8" speedo head screw on end and transmission end. They fit most all aftermarket mechanical speedo heads like Motorsport, Dolphin, VDO, Autometer, etc as well as stock.



## FORD AUTO • C4 • C6 • FMX AOD • 3 & 4 SPEED LATE MODEL

- SPEEDO CABLE** ..... 2601 ..... \$39.95 ea  
*Late model manual and C4-C6, FMX, AOD automatic transmission 71", we also make a 67" and a 76" if needed.*
- SPEEDO CABLE GROMMET** ..... 1617-G ..... \$2.90 ea
- SPEEDO CABLE "O" RING** ..... 2604-B ..... \$1.00 ea
- SPEEDO GEAR CLIP** ..... 2604-A ..... \$2.65 ea
- SPEEDO GEARS, C4 & C6 TRANS**  
*Most trucks need 18 teeth.*
- 18 teeth, yellow ..... 2603-Y ..... \$10.90 ea
- 19 teeth, pink ..... 2603-P ..... \$10.00 ea
- 16 teeth, maroon ..... 2603-M ..... \$10.00 ea
- SPEEDO CABLE LUBE** ..... 2607 ..... \$4.50 tb
- SPEEDO CABLE CLAMP** ..... 2605 ..... \$4.90 ea  
*Clamp is included with our cables, do not order separately*
- SPEEDO CLAMP BOLT & LOCK** ..... 82604 ..... \$0.95 ea

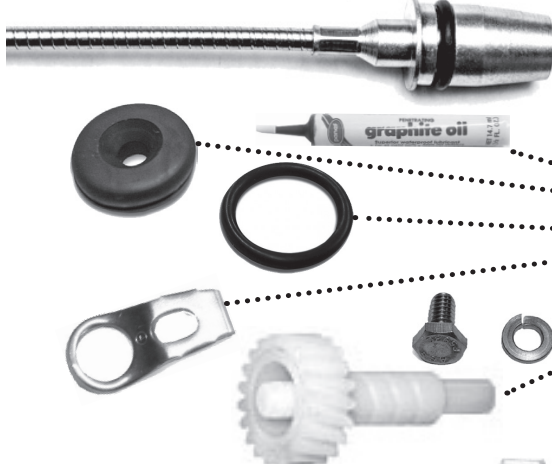

## ORIGINAL 3 SPEED MANUAL & AUTOMATIC

- SPEEDO CABLE**  
Stock 3 speed manual, automatic & overdrive  
With both ends & clamp ..... 2600 ..... \$27.50 ea
- Stock 4 speed manual ..... 2602 ..... \$29.50 ea
- SPEEDO CABLE LUBE** ..... 2607 ..... \$4.50 tb
- SPEEDO CABLE GROMMET** ..... 1617-G ..... \$2.90 ea
- SPEEDO CABLE "O" RING** ..... 2604-B ..... \$1.00 ea
- SPEEDO CABLE CLAMP** ..... 2605 ..... \$4.90 ea  
*This clamp is included with our cables, do not order separately*
- SPEEDO BOLT & LOCK** ..... 82604 ..... \$0.95 ea
- SPEEDO GEARS**
- 19 teeth ..... 2603-W19 ..... \$15.00 ea
- 20 teeth (most likely needed) ..... 2603-W20 ..... \$19.00 ea
- 21 teeth ..... 2603-W21 ..... \$15.00 ea
- 22 teeth ..... 2603-W22 ..... \$15.00 ea

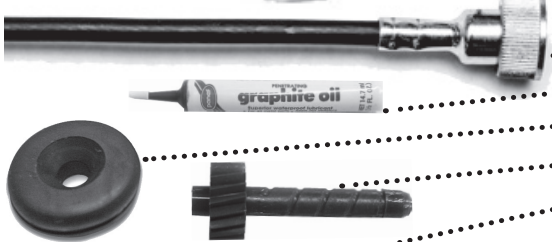

## CHEVY TRANSMISSIONS

- SPEEDO CABLE 1947-72 69"** ..... 2602 ..... \$29.50 ea
- SPEEDO CABLE LUBE** ..... 2607 ..... \$4.50 tb
- SPEEDO CABLE GROMMET** ..... 1617-G ..... \$2.90 ea
- SPEEDO GEAR, CHEVY 350** ..... 2603-C350 ..... \$18.50 ea

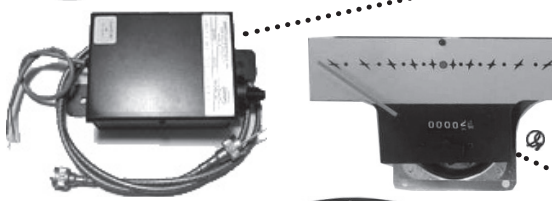

## SPEEDO HEAD CONVERTER

Converts an electronic transmission signal to the stock mechanical speedo head. Newer transmissions have electronic pulse senders and would need drive gears installed to use cable driven stock style speedo heads. This reads the electronic signal and converts it to cable drive, cable then operates stock (or other mechanical) style speedo heads. Complete ready to install ..... 2609 ..... \$379.00 ea



## SPEEDO HEAD

- 1953-55 ..... 2606-M5355 ..... \$175.00 ea
- 1956 ..... 2606-M56 ..... \$175.00 ea

Save even more, complete gauge set see page 44

