

SPEEDOMETER CABLE

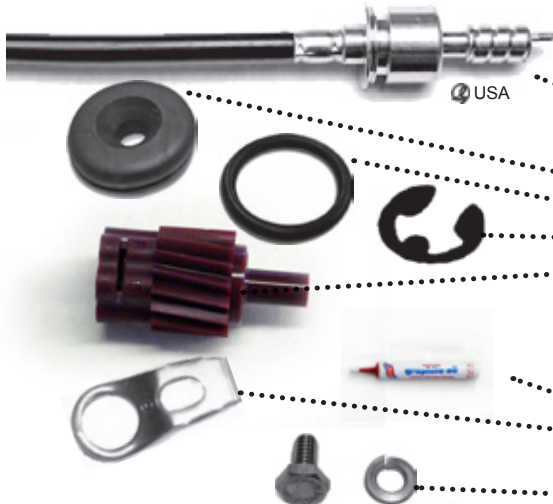

All our cables include inner drive cable, outer housing, 5/8" speedo head screw on end and transmission end. They fit most all aftermarket mechanical speedo heads like Motorsport, Dolphin, VDO, Autometer, etc as well as stock.



FORD AUTO • C4 • C6 • FMX AOD • 3 & 4 SPEED LATE MODEL

- SPEEDO CABLE** 2601 \$42.50 ea
Late model manual and C4-C6, FMX, AOD automatic transmission 71", we also make a 67" and a 76" if needed.
- SPEEDO CABLE GROMMET** 1617-G \$2.90 ea
- SPEEDO CABLE "O" RING** 2604-B \$0.75 ea
- SPEEDO GEAR CLIP** 2604-A \$2.65 ea
- SPEEDO GEARS, C4 & C6 TRANS**
Most trucks need 18 teeth.
- 18 teeth, yellow 2603-Y \$10.90 ea
- 19 teeth, pink 2603-P \$8.00 ea
- 16 teeth, maroon 2603-M \$10.00 ea
- SPEEDO CABLE LUBE** 2607 \$4.50 tb
- SPEEDO CABLE CLAMP** 2605 \$4.90 ea
Clamp is included with our cables, do not order separately
- SPEEDO CLAMP BOLT & LOCK** 82604 \$0.95 ea

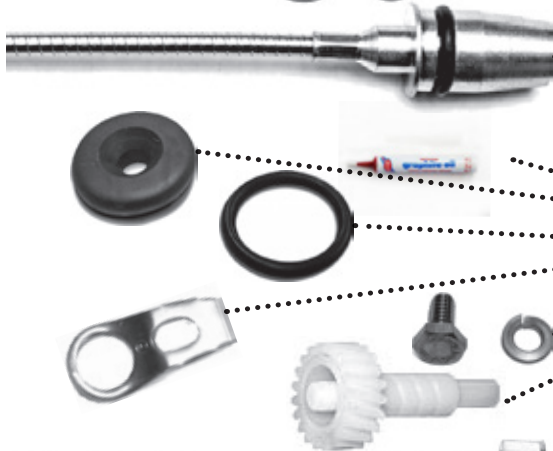

ORIGINAL 3 SPEED MANUAL & AUTOMATIC

- SPEEDO CABLE**
Stock 3 speed manual, automatic & overdrive
With both ends & clamp 2600 \$27.50 ea
- Stock 4 speed manual 2602 \$29.50 ea
- SPEEDO CABLE LUBE** 2607 \$4.50 tb
- SPEEDO CABLE GROMMET** 1617-G \$2.90 ea
- SPEEDO CABLE "O" RING** 2604-B \$0.75 ea
- SPEEDO CABLE CLAMP** 2605 \$4.90 ea
This clamp is included with our cables, do not order separately
- SPEEDO BOLT & LOCK** 82604 \$0.95 ea
- SPEEDO GEARS**
- 19 teeth 2603-W19 \$15.00 ea
- 20 teeth (most likely needed) 2603-W20 \$19.00 ea
- 21 teeth 2603-W21 \$15.00 ea
- 22 teeth 2603-W22 \$15.00 ea



CHEVY TRANSMISSIONS

- SPEEDO CABLE 1947-72 69"** 2602 \$29.50 ea
- SPEEDO CABLE LUBE** 2607 \$4.50 tb
- SPEEDO CABLE GROMMET** 1617-G \$2.90 ea
- SPEEDO GEAR, CHEVY 350** 2603-C350 \$18.50 ea

Examples: Numbers inside () are samples only, Fill in your findings this is just a rule of thumb, trans, tires, etc. effect it.
Truck faster (50 mph) than speedometer (45 mph) . . . Subtract 1 tooth per 5 miles. . . . If current gear is (20) you need 19 teeth
Truck slower (45 mph) than speedometer (50 mph) . . . Add 1 tooth per 5 miles. If current gear is (20) you need 21 teeth



SPEEDO HEAD CONVERTER

Converts an electronic transmission signal to the stock mechanical speedo head. Newer transmissions have electronic pulse senders and would need drive gears installed to use cable driven stock style speedo heads. This reads the electronic signal and converts it to cable drive, cable then operates stock (or other mechanical) style speedo heads.
Complete ready to install 2609 \$379.00 ea

SPEEDO HEAD

- 1953-55 2606-M5355 \$175.00 ea
- 1956 2606-M56 \$175.00 ea

Save even more, complete gauge set see page 44

