

ENGINE PARTS

ORIGINAL MOTOR MOUNTS

This part is not available

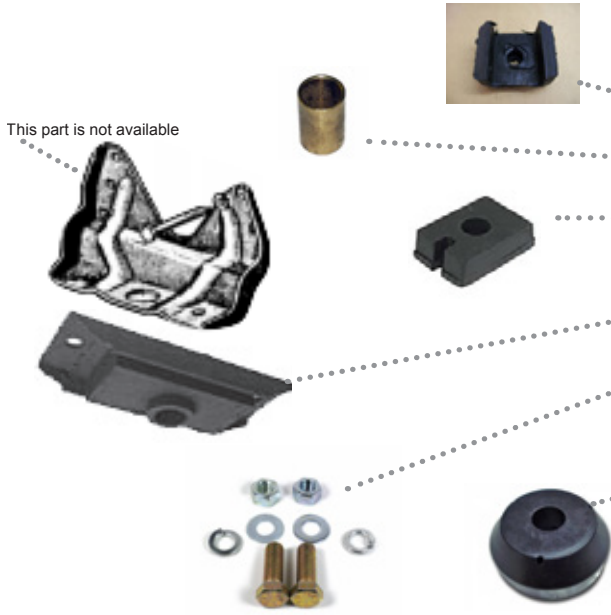

Rear side "u" pad, use 2	1405.....	\$15.00 ea
Bushing use 2.....	1421.....	\$4.00 ea
Rear side lower small pad use 2	1406.....	\$6.00 ea
Rear side bolt use 2.....	81407.....	\$4.50 ea
Front bar pad	1404.....	\$25.00 ea
Bar pad bolts	81404.....	\$3.50 set
Front bushing.....	1421.....	\$4.00 ea
Front round pad	1403	\$8.50 ea
Front center bolt	81407.....	\$4.50 ea

FLAT HEAD ENGINE PARTS

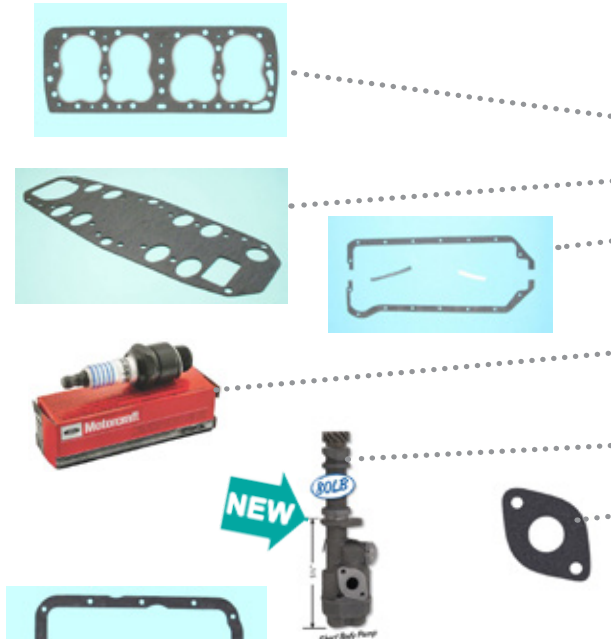

Cylinder head gaskets, R or L	4335-FG	\$33.00 ea
Intake manifold gasket.....	4339-FG	\$10.75 ea
Oil pan gasket.....	4334-FG	\$16.00 pr
Rear main seal	4338-FG	\$19.00 pr
Spark plugs, 239.....	1431	\$3.00 ea
Dip stick tube, 239.....	1417-4853 ..	\$12.00 ea
Oil pump, 80lb for 1939-53 flathead	1434.....	\$125.00 set
Oil pump gasket.....	1434-G.....	\$0.75 set

OTHER ENGINE AND TRANSMISSION PARTS

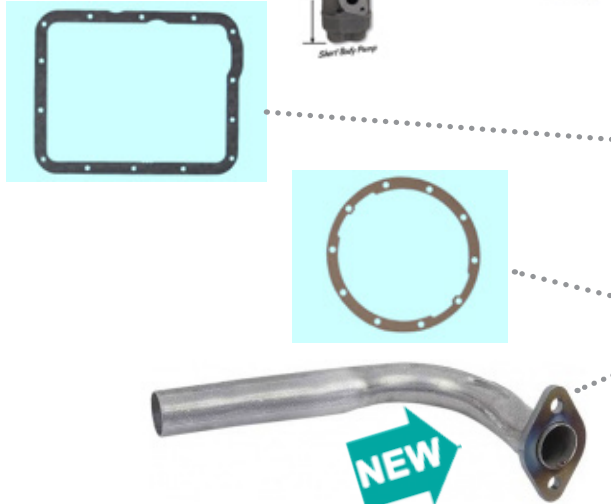

Trans oil pan, Ford-O-Matic, 1958-60	4451.....	\$9.00 ea
Trans oil pan, Ford-O-Matic.....	4450.....	\$7.25 ea
Trans oil pan, Cruise-O-Matic.....	4452.....	\$7.25 ea
Rear end carrier gasket.....	1338.....	\$4.50 ea
V8 single exhaust crossover pipe, 1953.....	1461.....	\$45.00 ea