

ENGINE PARTS

ORIGINAL MOTOR MOUNTS

This part is not available



- Rear side "u" pad, use 2 1405 \$15.00 ea
- Bushing use 2 1421 \$4.95 ea
- Rear side lower small pad use 2 1406 \$6.00 ea
- Rear side bolt use 2 81407 \$4.50 ea
- Front bar pad 1404 \$19.95 ea
- Bar pad bolts 81404 \$3.50 set
- Front bushing 1421 \$4.95 ea
- Front round pad 1403 \$5.95 ea
- Front center bolt 81407 \$4.50 ea

FLAT HEAD ENGINE PARTS

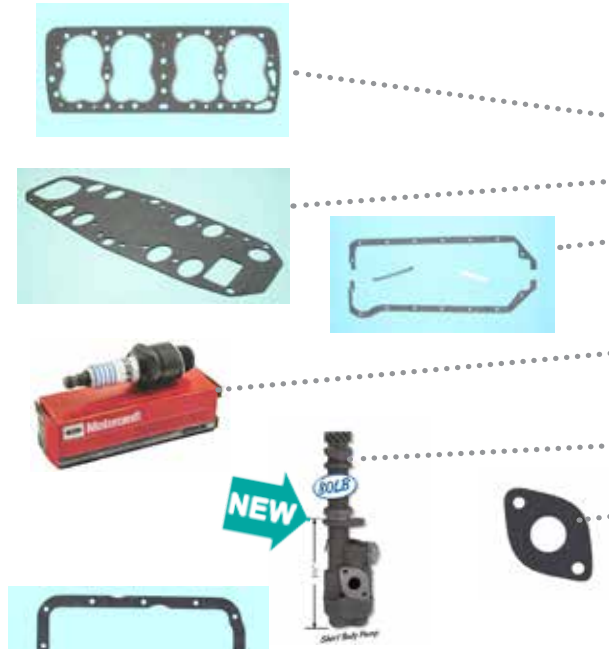

- Cylinder head gaskets, R or L 4335-FG \$33.00 ea
- Intake manifold gasket 4339-FG \$10.75 ea
- Oil pan gasket 4334-FG \$16.00 pr
- Rear main seal 4338-FG \$19.00 pr
- Spark plugs, 239 1431 \$3.00 ea
- Dip stick tube, 239 1417-4853 .. \$12.00 ea
- Oil pump, 80lb for 1939-53 flathead 1434 \$125.00 set
- Oil pump gasket 1434-G \$0.75 set

OTHER ENGINE AND TRANSMISSION PARTS

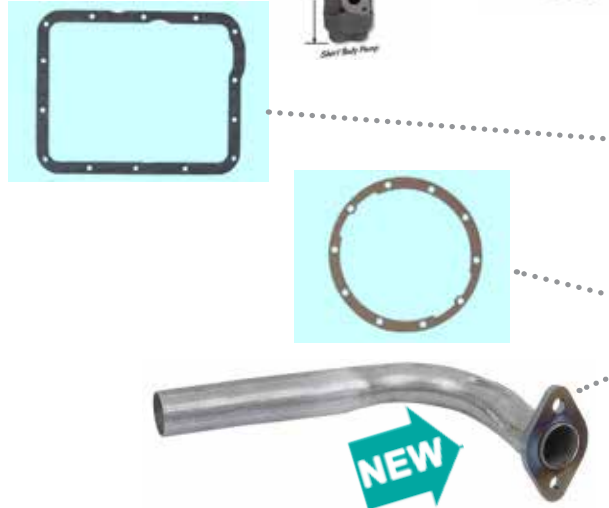

- Trans oil pan, Ford-O-Matic, 1958-60 4451 \$9.00 ea
- Trans oil pan, Ford-O-Matic 4450 \$7.25 ea
- Trans oil pan, Cruise-O-Matic 4452 \$7.25 ea
- Rear end carrier gasket 1338 \$4.50 ea
- V8 single exhaust crossover pipe, 1953 1461 \$45.00 ea