

BRAKE LINES • PARKING BRAKE

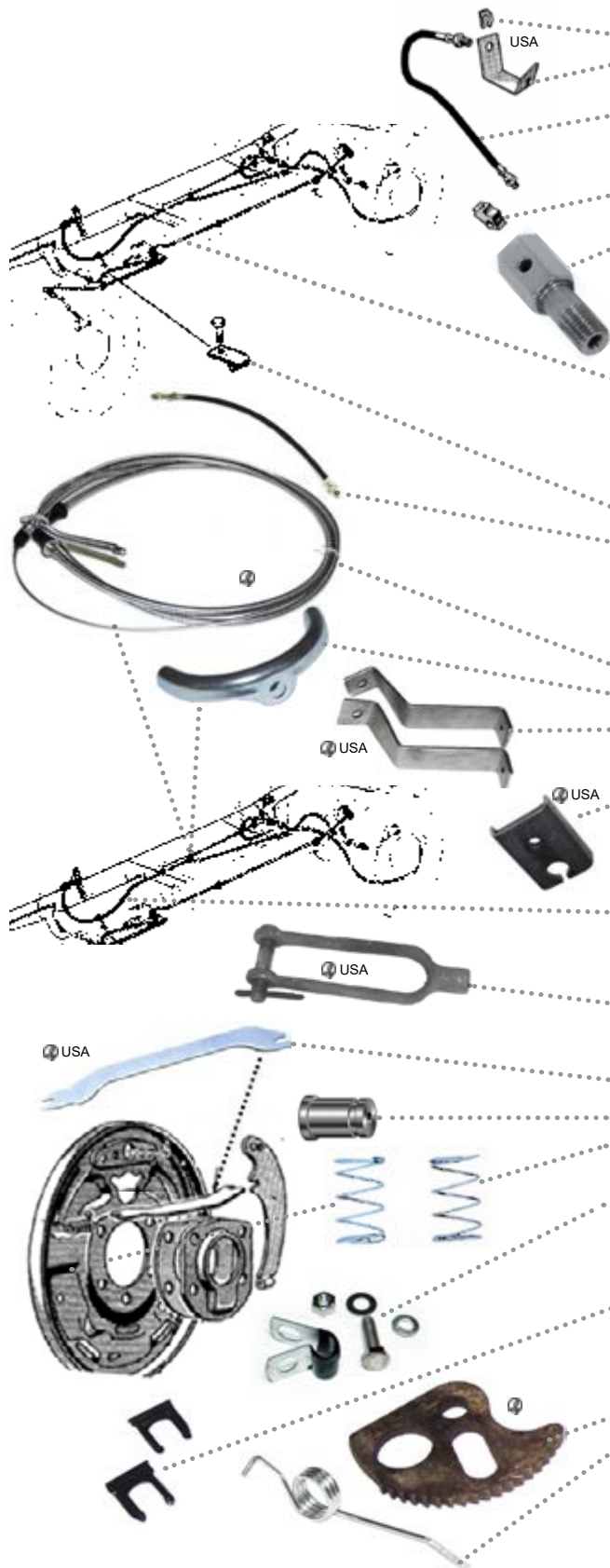

- BRAKE LINES AND HOSES**
- Rear brake hose retaining clip.....0554 \$1.95 ea
 - Rear brake hose frame bracket.....0530..... \$9.50 ea
 - Brake bracket bolt.....80530..... CALL
 - Rear brake hose.....0525..... \$24.00 ea

Only one needed in center, goes to the center block fitting

- Center fitting to hose washer.....0523..... \$1.20 ea
- Rear brake center block fitting.....0522..... \$18.00 ea
- Rear brake center block fitting, F-250F2-0522 CALL
- Rear end vent, polished, long neck.....1336..... \$12.75 ea
- "S"line clip, joins fuel & brake line1636..... \$2.00 ea

Steel brake lines
For stock brakes, pre-bent 3/16" hard lines complete with proper ends and wrap installed, made from Ford specs.

- Stainless.....5905-SS..... \$175.00 kit
- Stock steel.....5904-SK..... \$150.00 set

- D-Y-I brake line kit**
Includes 30 feet of tube, fittings, unions, spring wrap and clips
- Stainless.....5901-S \$139.95 kit
 - Plain steel.....5901-K \$75.00 kit
 - Brake line clip & bolt.....0526..... \$1.50 ea
 - Stock brakes front brake hose, use 2.....0524..... \$20.00 ea

- REAR PARKING/EMERGENCY BRAKE CABLE**
Goes to both rear wheels, fits stock rear end and most Ford 9 inch rear ends.
- Stock rear cable with yoke0552..... \$52.50 ea
 - Stock rear cable, no yoke.....0552-NY CALL
 - Center yoke0556..... \$6.50 ea

Got cable elsewhere? "Yokes on you" you need a yoke

- Cable to frame bracket, steel, pair0560..... \$22.50 pr
- Cable to frame bracket, stainless0560-SS..... \$25.00 pr
- Bracket mounting bolts.....80560..... \$2.00 pr
- Rear cable mounting tab0563..... \$10.00 ea

At crossmember secures brake cable, truck needs 2

- Tab mounting bolts80563..... \$1.85 pr

- FRONT PARKING BRAKE CABLE**
- Cable0551..... \$47.50 ea
 - Front cable adjusting nuts80553..... \$0.50 set
- One for clevis below, and 2 for cable at yoke, adjusts tension*
- Front cable adjusting clevis0555..... \$12.50 ea
- Not casting like original, made in steel, fits correctly*
- Pin & cotter80555..... \$2.50 set

- **BRAKE SPREADER BAR for E-brake**.....0542..... \$14.50 ea
- **PULL LEVER LINK PIN**.....0539..... \$2.75 ea
- **SPREADER BAR SPRING**.....0537..... \$4.00 pr

1 pr per wheel

CABLE CLAMP & BOLT.....CABLE & HOSE

- **RETAINER CLIP**.....0554..... \$1.95 ea

1 at front crossmember, 2 at rear crossmember, 1 at rear hose.

- HORSE-SHOE CLIP AT HOSE AND CABLE ENDS**
- Smaller of the clips (pair).....0553..... \$4.75 pr
- PARK BRAKE HANDLE**Not available
- Handle bolts, polished stainless80551-PX..... \$8.50 kit

- PARKING BRAKE HANDLE REPAIR PIECES**
- Sector gear, NOS0559..... \$11.75 ea
 - Park handle inner repair spring0558..... \$8.25 ea
- Expensive but is most often problem with broken handle.*

