

## Temperature sending units, original

PART NUMBERS  
2940  
6V-2941  
6V-2942-2  
  
PAGE NUMBER  
1 OF 1

**\*%#@#! INSTRUCTIONS**  
**MID FIFTY F-100 PARTS 1-800-252-1956**

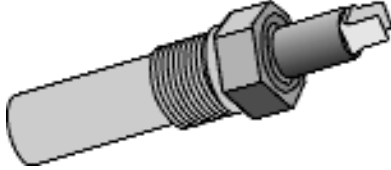

12 Volt .....2940  
6 Volt Single Post .....6V-2941  
6 Volt Double Post .....6V-2942-2

TEMPERATURE SENDING UNIT. For original engines only, to fit later model engines thread adapters are necessary. If using later model engine please check our catalog for newer reproduced sending units and gauges.

- \*Sender is self resetting and will not begin to function again until engine cools below 120 degrees.
- \*Original gauge is at rest on hot, turn ignition on and gauge goes to cold then warms as engine warms. These original sending units are very slow to warm.
- \*Warm is 110 degrees.
- \*12 Volt sender has two posts, only one is used. (second post is only used for flat head)
- \*Wire from either post to Gauge. Gauge to ACC. post on Ignition switch.
- \*6 Volt sender, Single post is used for 6 Cyl. engine or Passenger side of Flat head motor.
- \*6 Volt sender, Double post is used for Driver side of Flat head motor only.

## Temperature sending units, original

PART NUMBERS  
2940  
6V-2941  
6V-2942-2  
  
PAGE NUMBER  
1 OF 1

**\*%#@#! INSTRUCTIONS**  
**MID FIFTY F-100 PARTS 1-800-252-1956**

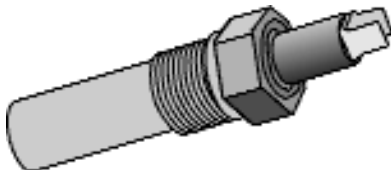

12 Volt .....2940  
6 Volt Single Post .....6V-2941  
6 Volt Double Post .....6V-2942-2

TEMPERATURE SENDING UNIT. For original engines only, to fit later model engines thread adapters are necessary. If using later model engine please check our catalog for newer reproduced sending units and gauges.

- \*Sender is self resetting and will not begin to function again until engine cools below 120 degrees.
- \*Original gauge is at rest on hot, turn ignition on and gauge goes to cold then warms as engine warms. These original sending units are very slow to warm.
- \*Warm is 110 degrees.
- \*12 Volt sender has two posts, only one is used. (second post is only used for flat head)
- \*Wire from either post to Gauge. Gauge to ACC. post on Ignition switch.
- \*6 Volt sender, Single post is used for 6 Cyl. engine or Passenger side of Flat head motor.
- \*6 Volt sender, Double post is used for Driver side of Flat head motor only.