

1953-55 WIPER MOTOR

INST-3000-5355

3000-5355

PAGE 1 OF 1

#@\$!*@#\$\$% INSTRUCTIONS
MID FIFTY F-100 PARTS 1-800-252-1956

INSTALL WIPER MOTOR

STEP 1

Remove original vacuum wiper motor unit from it's position under the dash and block off the vacuum source. Remove windshield wiper arms from the wiper tower drives.

STEP 2

Using the existing support brackets and the holes to the right side on the mounting brackets, place the electric wiper motor assembly into position. (See Figure 1) Place the 2 rubber pads between the motor mounting plate and the support brackets. Insert the bolts from the firewall side and secure the wiper motor assembly with the nuts.

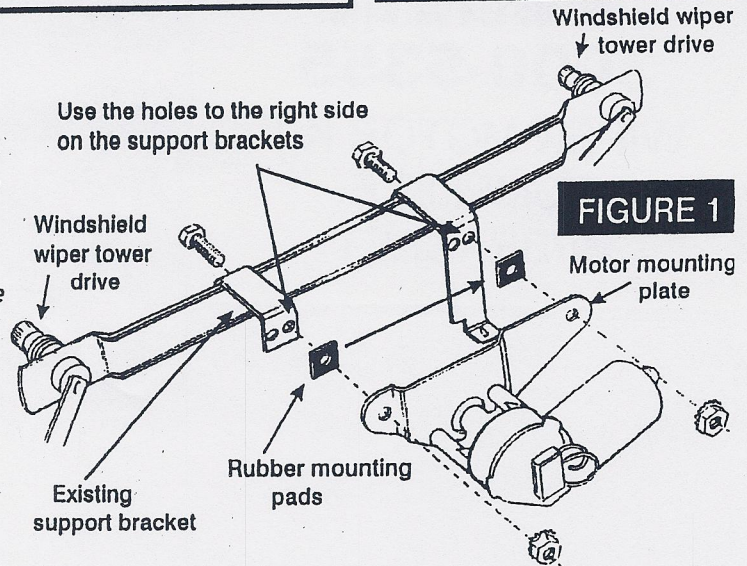

STEP 3

Attach the driver's side wiper link to the wiper motor drive pin first, then attach the passenger's side wiper link to the drive pin (See Figure 2). The links are secured to the drive pin by use of a retaining clip.

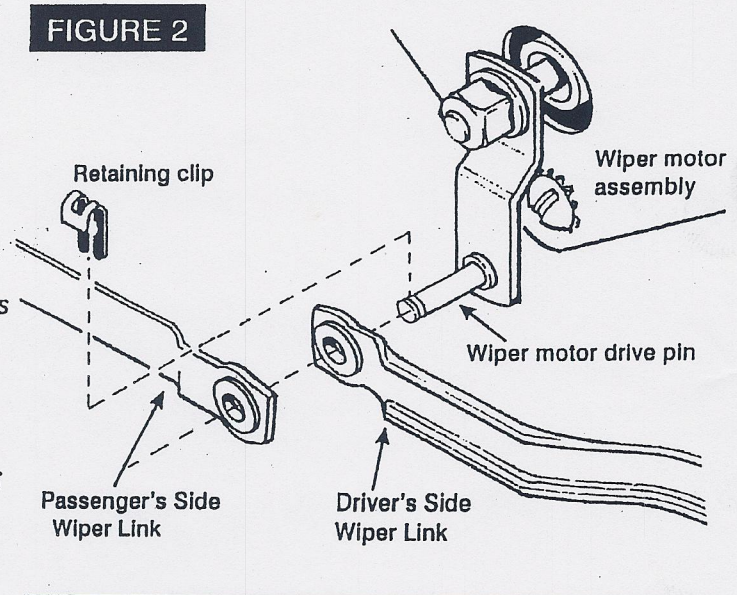

STEP 4

Connect the electric wiper motor wiring system and install the wiper on/off switch as described on the WIRING DIAGRAM displayed on the reverse side of this sheet.

STEP 5

To test the wiper motor stop position, (DO NOT REINSTALL THE WINDSHIELD WIPERS AT THIS TIME) turn on the motor then turn it off. Make note where the windshield wiper tower drives stop.

STEP 6

After the stop position has been determined reinstall the windshield wipers onto the wiper tower drives.

STEP 7

If the windshield wipers in stop position need further adjustment, it is possible to remove the motor drive arm from the shaft, rotate the arm slightly clock wise or counter clockwise then reinstall the arm to the shaft. (See figure 3)

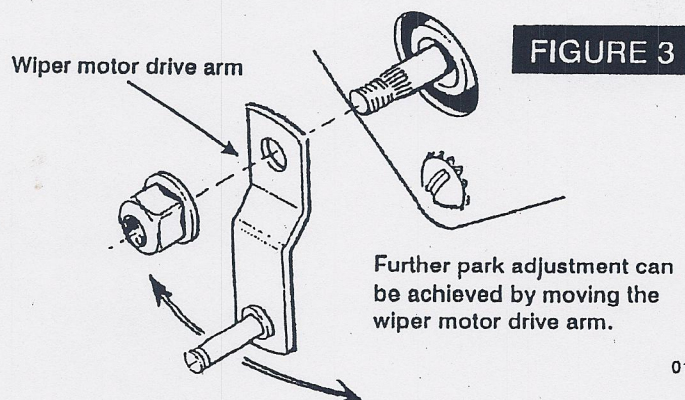

011305

WIPER SWITCH

INST-2908
2908
2909
3000-all
PAGE 1 OF 1

#@\$!*@#\$\$% INSTRUCTIONS
MID FIFTY F-100 PARTS 1-800-252-1956

Wiper switches have changed many times in the last 50 years.
Wiper motors have also changed.

**Most switches and motors will not interchange, the switch needs to match the motor.

**1953-55 wiper switches and motors were originally 6 Volt, positive ground. They can be rewound to 12 volt negative ground, this was common years ago but few places do it now.

**6 Volt motors and switches will run on 12 Volt, they just run fast, won't last as long, but will run a long time if only run on low speed. Remember to protect wiring with an in-line fuse.

**Original motors had the wires coming out of the head. The head cover was steel and the inside gear was fiberboard. We used to chrome the motor head cover or the complete motor housing and could even replace the gear, ahhhhh, days gone by!!!! In recent years the motor head no longer has a replaceable gear and is plastic, yuck!! and ugly, hence the Polished Stainless 1956 Motor cover we make to cover the nasty thing. (53-55 hides under the dash)

**New wiper motors have a plug in wire connector. Same idea, there are 3 wires to the motor, High, Low, and Park. Park is what makes wipers continue to the down position after you have turned off the switch.

**POWER should always come directly from Ignition Switch, ACC post or GA post on 6 volt.

**The wiper switch was never fused originally but we suggest an in-line fuse today,
7 1/2 amp fuse.

CURRENT MOTOR & SWITCH

Black wireGROUND
Gray wireP...PARK
White wireL...LOW
Red wireH...HIGH
Green wireB...POWER, for park
..... goes to one B post
Gray wire with fuse holder.. Power from Ign switch ACC post to other B on switch

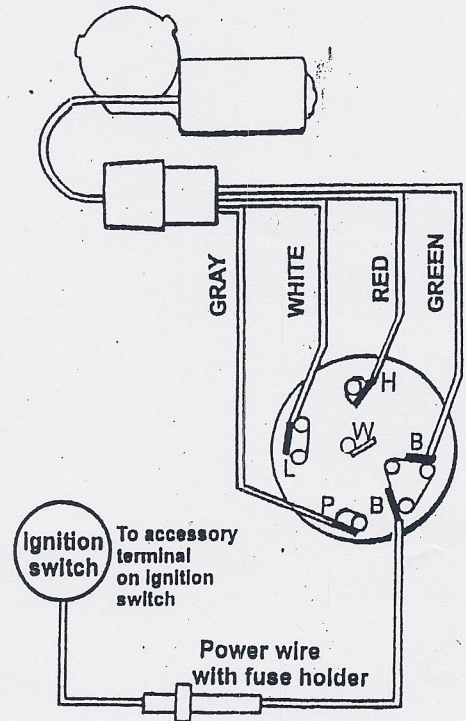

VARIOUS SWITCH WIRING USED IN 1953-56 TRUCKS FROM THEN TO TODAY

This is only some of them, If your switch does not have these markings, well, Good Luck!!!! Just test the thing to see which connector lights up at which position the knob is turned to. Many newer switches have a wash position built in that is not used with these motors.

ORIGINAL SWITCH	
ARed (high)
FGreen (low)
PPark
BPower

REPLACEMENT SWITCH	
HRed (high)
LGreen (low)
PPark
BPower

REPLACEMENT SWITCH	
2Red (high)
1Green (low)
5Park
BPower
3Ignore
4Ignore

REPLACEMENT SWITCH	
2Red (high)
1Green (low)
5Park
BPower
WWasher, ignore

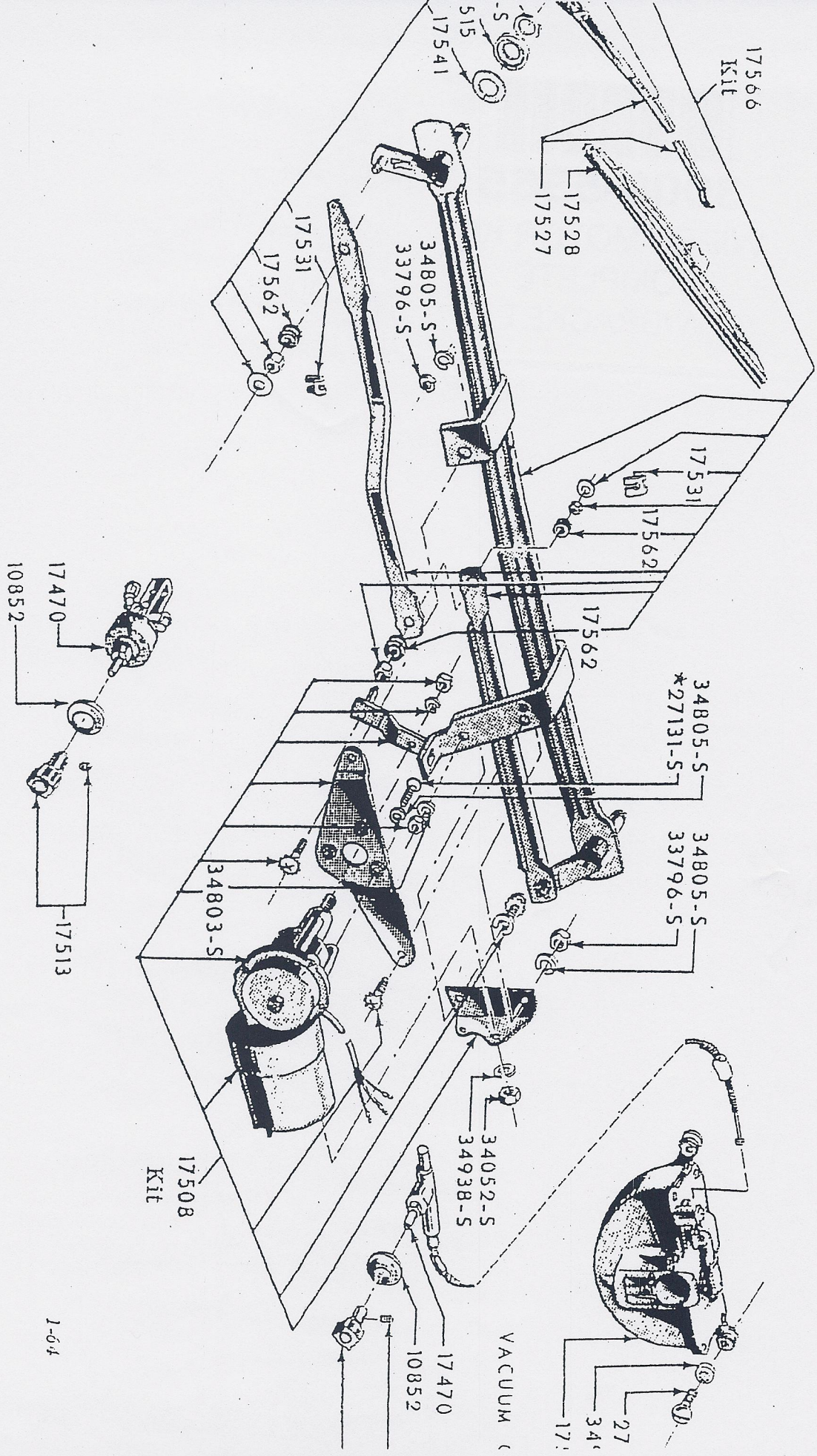

1953/55 "TYPICAL" WINDSHIELD WIPER
 (ELECTRIC AND VACUUM)

P-148C

1-64