

Windshield weatherstrip installation

Created, written, & illustrated by: Chuck Frank

Last revision: 10/06/2015

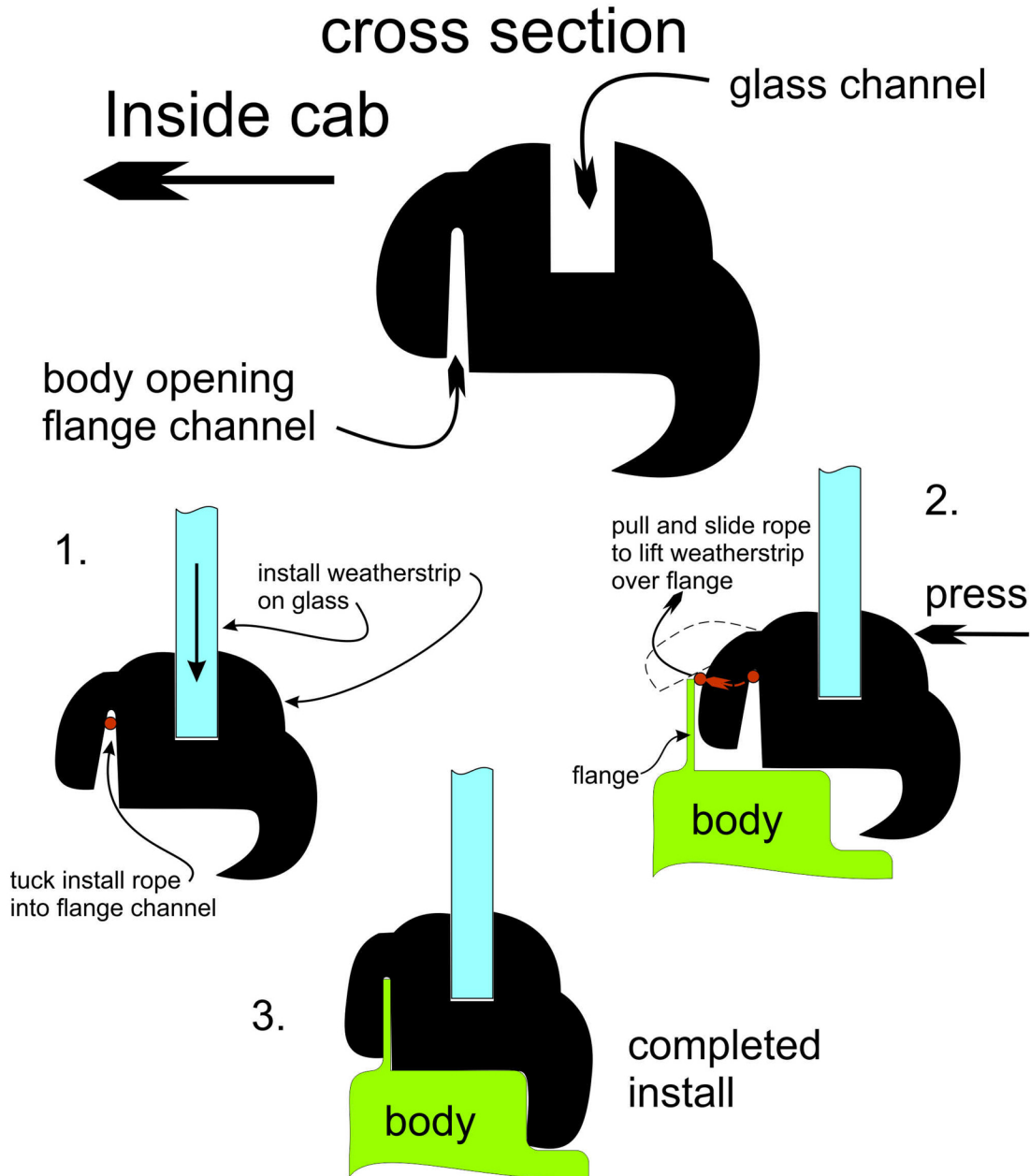

Instructions: 1. weatherstripping is installed on glass. Note glass is larger than opening in body. Temp install rope is tucked into flange channel in weatherstripping, ends overlapping and extending out at top. Tying handles to rope ends may make install easier.
2. Windshield is installed from outside. Glass and weatherstripping is pressed against body opening flange from outside.
Rope is slowly pulled and slid around body flange on inside to lift inner portion of weatherstripping over flange.
3. Installation is complete!

Note: rear glass is installed in similar manner except weatherstrip is reversed and glass is installed from inside cab.